



131 County Rd. 34E.  
Jackson, MN 56143  
www.hitchdoc.com

Telephone 1-800-446-8222  
507-847-4049  
Fax 507-847-5100  
questions@hitchdoc.com

## Harley Davidson Street Glide 2010-2013 H15214 Installation Instructions

**\*ALWAYS CHECK BOLT LENGTH FOR TIRE CLEARANCE\***

**This hitch is designed for a completely stock motorcycle. If the rear shocks, suspension, or tire have been adjusted/changed in any way, it is up to the customer to verify that there isn't any interference between the hitch and any part of the motorcycle.**

These instructions are written as you are installing the hitch from the back of the bike so "left" would refer to the roadside and "right" would refer to the curbside.

Have a friend help with installing the hitch. We recommend that you use "Loctite" (blue) on all bolts so that they do not come loose during your ride.

Read all instructions carefully before attempting installation. Do not fully tighten bolts until installation is complete, unless instructed to do so.

*Note: This bike has an optional docking kit. This hitch does **NOT** ship with the appropriate docking kit hardware. For hardware, order part #H15231.*

| <b>Tools:</b> |                     |
|---------------|---------------------|
| T-25 Torx Bit | 7/16" Wrench/Socket |
| T-40 Torx Bit | 1/2" Wrench/Socket  |

1. Unpack the hitch and verify that all parts and fasteners are present and free of defects. Refer to the included hitch drawing to help identify the parts included with the hitch.
2. Open each saddle bag and untwist the two Dzus "quarter-turn" fasteners in each bag to release the saddle bags from the bike. Disconnect the electronic wire connector located between the saddle bag and the motorcycle frame toward the front of the bag. Set each bag off to the side.
3. Remove the seat strap bracket with the strap and the chrome rail covers on each side.
4. To remove the taillight housing, loosen the two lower bolts on each side and remove the one upper bolt on each side. Also, remove the bolt for the muffler support. Carefully work the housing loose from the cycle fender and tip it backwards to unclip the electronic connector.
5. Remove the metal guard on the front of the taillight housing and disconnect the electronic connectors located on the left and right side of the taillight box. The taillight housing can now be removed.
6. Two people are strongly recommended for this step. Slide the hitch in place from the rear of the motorcycle taking great care to not bump it against the bike. Line the hitch up

with the three holes in the frame and place a 5/16" x 1" bolt [Item 13, H17104] into the front most hole on each side of the bike to support the hitch. Slowly lower the hitch until it is resting against the bike.

7. Reconnect the electronic connectors and reinstall the metal guard to the taillight housing. Carefully maneuver the housing into place under the fender and around the loosened fasteners. Re-tighten the two lower bolts on each side and re-insert the upper bolt on each side to re-secure the taillight housing.
8. Remove the antenna bracket located on the left side of the bike. A new bracket will be attached to the left side arm on the hitch instead.
9. Move the hitch into final working position and install the lower hitch side support brackets [Item 3, H15230 300 and Item 4, H15230 400] on both sides reversing the factory bolts so that the head will be towards the rear of the bike.
10. Install the remaining two 5/16 x 1" bolts [Item 13, H17104] into the rear most holes on the hitch on each side.
11. Install the rail cover using the 5/16" x 1-1/4" chrome button head bolt [Item 10, H17040] and 5/16" chrome washer [Item 4, H17039]. Re-attach the seat strap and tighten both sides securely.
12. Remount the saddle bags by reconnecting the electronic wire connector that is between the frame of the bike and the saddle bag and then continue placing the saddle bag into position and reattach it to the bike using the Dzus quarter turn fasteners that were removed in Step 3.
13. Attach the new antenna bracket [Item 1, H15210 300] to the left side of the hitch using the two #10 x 1/2" screws [Item 12, H17042] and two #10 nuts [Item 11, H17041]. Mount the antenna to the new bracket.
14. (Optional) Install the mud flap/safety chain bracket [Item 20, H19904] using the 1/4"-20 x 1" hex bolts [Item 8, H17019], 1/4" flat washers [Item 7, H17008], 1/4" lock washers [Item 5, H17003], and 1/4" hex nuts [Item 6, H17004].
15. Insert the shaft of the chrome receiver [Item 19, H18025C] into the bottom of the painted receiver bracket and temporarily insert the receiver pin [Item 16, H17890C] through the holes of both parts (it doesn't matter which side of the bracket the pin is inserted). To remove excess rattle, tighten the 3/8"-24 x 1/2" rattle bolt [Item 18, H17913] on the top side of the hitch. Keep tightening until when you remove the pin, the receiver stays in place. Now, holding onto the bottom of the receiver, loosen the bolt (about a quarter turn or less) until the receiver is able to be removed from the hitch. Reinsert the receiver and the pin and secure it by inserting the hair pin clip [Item 17, H17899] into the hole in the end of the pin by pushing firmly until the middle of the clip is over the pin.

It is the operator's responsibility to periodically check all fasteners/mounting hardware to ensure none have come loose during use and to check for any signs of wear.

Thank you for purchasing a quality hitch made by HitchDoc, Mfg. Enjoy!

# H15214 STREETGLIDE '10-'13, HITCH W/RECEIVER

| ITEM NO. | PART NUMBER | QTY. | DESCRIPTION                               |
|----------|-------------|------|---|
| 1        | H15210 300  | 1    | ANTENNA MOUNT                             |
| 2        | H15214C     | 1    | HITCH, STREETGLIDE '10-'13, CHROME        |
| 3        | H15230 300  | 1    | SUPPORT BRACKET, RIGHT                    |
| 4        | H15230 400  | 1    | SUPPORT BRACKET, LEFT                     |
| 5        | H17003      | 2    | WASHER, 1/4" SPLIT-LOCK, ZN               |
| 6        | H17004      | 2    | NUT, 1/4"-20 HEX, ZN                      |
| 7        | H17008      | 8    | WASHER, 1/4" FLAT USS, ZINC               |
| 8        | H17019      | 2    | BOLT, 1/4"-20 X 1 HEX, GR5 ZN             |
| 9        | H17039      | 4    | WASHER, 5/16" FLAT, CHROME                |
| 10       | H17040      | 2    | BOLT, 5/16"-18 X 1-1/4 BHHEX, CHROME      |
| 11       | H17041      | 2    | NUT, 10-24 HEX, ZN                        |
| 12       | H17042      | 2    | BOLT, 10-24 X 1/2 SHCS, ZN                |
| 13       | H17104      | 4    | BOLT, 5/16"-18 X 1 HEX, GR5 ZN            |
| 14       | H17118      | 2    | SCREW, 5/16"-18 X 1/2 BHHEX, CHROME       |
| 15       | H17512      | 2    | BUSHING, 0.70 OD X 0.33 ID X 0.16, CHROME |
| 16       | H17890C     | 1    | RECEIVER PIN, SHORT                       |
| 17       | H17899      | 1    | HAIR PIN, 3/32" X 1-1/4, ZINC             |
| 18       | H17913      | 1    | BOLT, 3/8"-24 X 1/2 HEX, GR5 ZN           |
| 19       | H18025C     | 1    | RECEIVER, ANGLED 2" O.S., CHROME          |
| 20       | H19904      | 1    | TOW HOOK/MUDFLAP BRACKET                  |

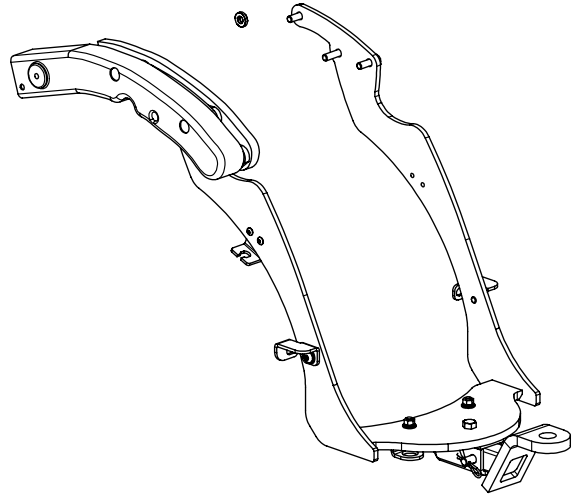

**ASSEMBLED VIEW**

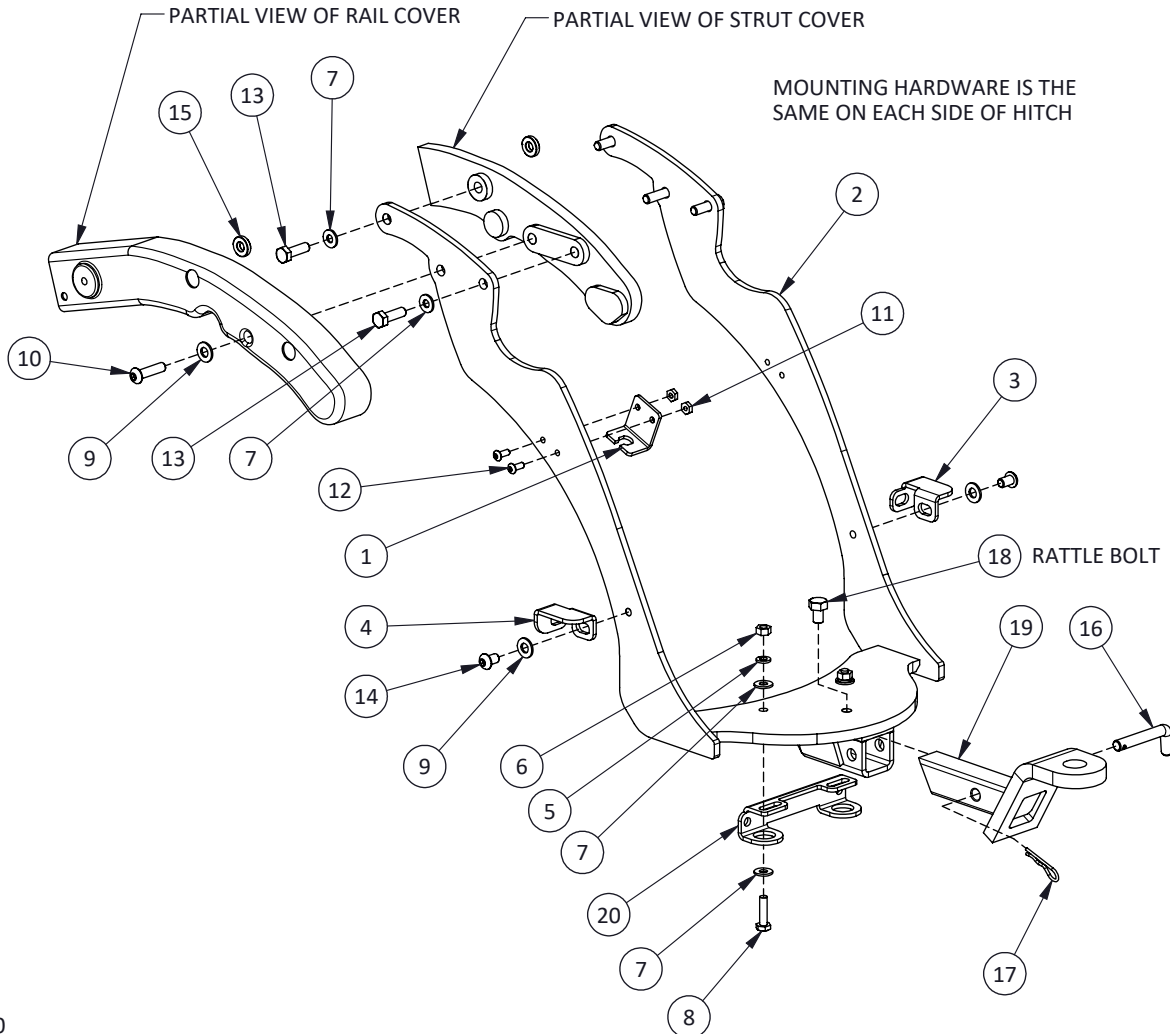

HDW930  
REVA ECO 1611

REPRODUCTION IN PART OR AS A WHOLE WITHOUT THE WRITTEN PERMISSION OF HITCHDOC, MFG. IS PROHIBITED.

**\*ALWAYS CHECK BOLT LENGTH FOR TIRE CLEARANCE\***