



131 County Rd. 34E.  
Jackson, MN 56143

Telephone 1-800-446-8222

507-847-4049

Fax

507-847-5100

questions@hitchdoc.com

## **HD FXRT Hitch**

### **H15040 Installation Instructions**

**\*ALWAYS CHECK BOLT LENGTH FOR TIRE CLEARANCE\***

**This hitch is designed for a completely stock motorcycle. If the rear shocks, suspension, or tire have been adjusted/changed in any way, it is up to the customer to verify that there isn't any interference between the hitch and any part of the motorcycle.**

These instructions are written as you are installing the hitch from the back of the bike so "left" would refer to the roadside and "right" would refer to the curbside.

Have a friend help with installing the hitch. We recommend that you use "Loctite" (blue) on all bolts so that they do not come loose during your ride.

Read all instructions carefully before attempting installation. Do not fully tighten fasteners until installation is complete, unless instructed to do so.

1. Unpack the hitch and verify that all parts and fasteners are present and free of defects. Refer to the included hitch drawing to help identify the parts included with the hitch.
2. Remove existing bushing on backside of bag bracket. Put hitch in its place on the bike. The small bushing provided goes inside the fender socket to help hold the weight.
3. Use the large bushing only if needed to even out the bags. Use bushing on the inside lower frame where saddlebag bolts to bracket between saddlebag and saddlebag bracket.
4. *(Optional)* Install the mud flap/safety chain bracket [*Item 7, H19904*] using the 1/4"-20 x 1" hex bolts [*Item 5, H17019*], 1/4" flat washers [*Item 4, H17008*], 1/4" lock washers [*Item 2, H17003*] and 1/4" hex nuts [*Item 3, H17004*].

It is the operator's responsibility to periodically check all fasteners/mounting hardware to ensure none have come loose during use and to check for any signs of wear.

Thank you for purchasing a high quality hitch made by HitchDoc, Mfg. Enjoy!

## H15040 HD FXRT HITCH

| ITEM NO. | PART NUMBER | QTY. | DESCRIPTION                   |
|----------|-------------|------|-------------------------------|
| 1        | H15040C     | 1    | FXRT CHROME HITCH             |
| 2        | H17003      | 2    | WASHER, 1/4" SPLIT-LOCK, ZN   |
| 3        | H17004      | 2    | NUT, 1/4"-20 HEX, ZN          |
| 4        | H17008      | 4    | WASHER, 1/4" FLAT USS, ZINC   |
| 5        | H17019      | 2    | BOLT, 1/4"-20 X 1 HEX, GR5 ZN |
| 6        | H17502      | 2    | BUSHING, LARGE                |
| 7        | H17503      | 2    | BUSHING, SMALL                |
| 8        | H19914      | 1    | TOW HOOK/MUDFLAP BRACKET      |

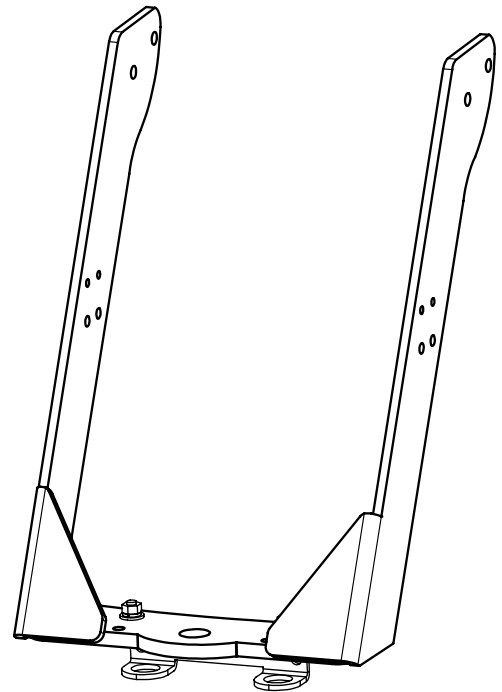
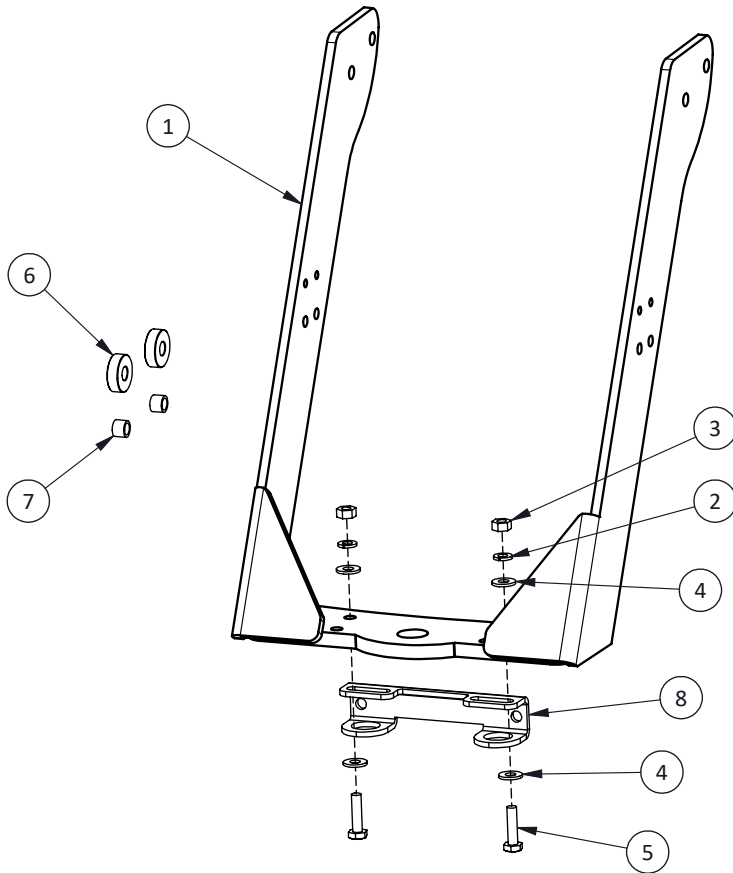

ASSEMBLED VIEW

HDW2992  
REVA ECO 1611

REPRODUCTION IN PART OR AS A WHOLE WITHOUT THE WRITTEN PERMISSION OF HITCHDOC, MFG. IS PROHIBITED.

**\*ALWAYS CHECK BOLT LENGTH FOR TIRE CLEARANCE\***