



131 County Rd. 34E.  
Jackson, MN 56143  
www.hitchdoc.com

Telephone 1-800-446-8222  
507-847-4049  
Fax 507-847-5100  
questions@hitchdoc.com

## Harley Davidson Sportster (2004-2009)

### H15015 Installation Instructions

**\*ALWAYS CHECK BOLT LENGTH FOR TIRE CLEARANCE\***

**This hitch is designed for a completely stock motorcycle. If the rear shocks, suspension, or tire have been adjusted/changed in any way, it is up to the customer to verify that there isn't any interference between the hitch and any part of the motorcycle.**

These instructions are written as you are installing the hitch from the back of the bike so "left" would refer to the roadside and "right" would refer to the curbside.

Have a friend help with installing the hitch. We recommend that you use Loctite (blue) on all bolts so that they do not come loose during your ride. Use the attached drawing page to help with part identification during installation.

Read all instructions carefully before attempting installation. Do not fully tighten fasteners until installation is complete, unless instructed to do so.

1. Unpack the hitch and verify that all parts and fasteners are present and free of defects. Refer to the hitch drawing to identify the parts included with the hitch.
2. (Optional) Install the mud flap/safety chain bracket [Item 16, H19914] using the 1/4"-20 x 1" hex bolts [Item 5, H17019], 1/4" flat washers [Item 4, H17008], 1/4" lock washers [Item 2, H17003] and 1/4" hex nuts [Item 3, H17004].
3. Remove the one bolt behind and one bolt in front of the rear taillight on the rear fender on each side.
4. Slide the hitch [Item 1, H15015C] into place from the rear of the motorcycle between the mufflers and spread the arms to go over the chrome strut with the taillight in the cutout between the two holes in the hitch arms. Line the holes up with the location where the bolts were just removed from and then re-install the bolts that were just removed. Do not fully tighten.
5. Check the hitch for clearance on the fender of the motorcycle and clearance on the tire. Adjust and center the hitch as needed and then fully tighten all of the hardware working in a criss-cross pattern alternating from right front to left rear, then left front to right rear to help keep the hitch centered on the bike.

It is the operator's responsibility to periodically check all fasteners/mounting hardware to ensure none have come loose during use and to check for any signs of wear.

Thank you for purchasing a quality hitch made by HitchDoc, Mfg.

# H15015 HD SPORTSTER 04-09

ITEM NO.	PART NUMBER	QTY.	DESCRIPTION
1	H15015C	1	HITCH WLDMT, SPORTSTER 04-08
2	H17003	2	WASHER, 1/4" SPLIT-LOCK, ZN
3	H17004	2	NUT, 1/4"-20 HEX, ZN
4	H17008	4	WASHER, 1/4" FLAT USS, ZINC
5	H17019	2	BOLT, 1/4"-20 X 1 HEX, GR5 ZN
6	H19914	1	TOW HOOK/MUDFLAP BRACKET

MOUNTING HARDWARE IS THE SAME ON EACH SIDE OF HITCH

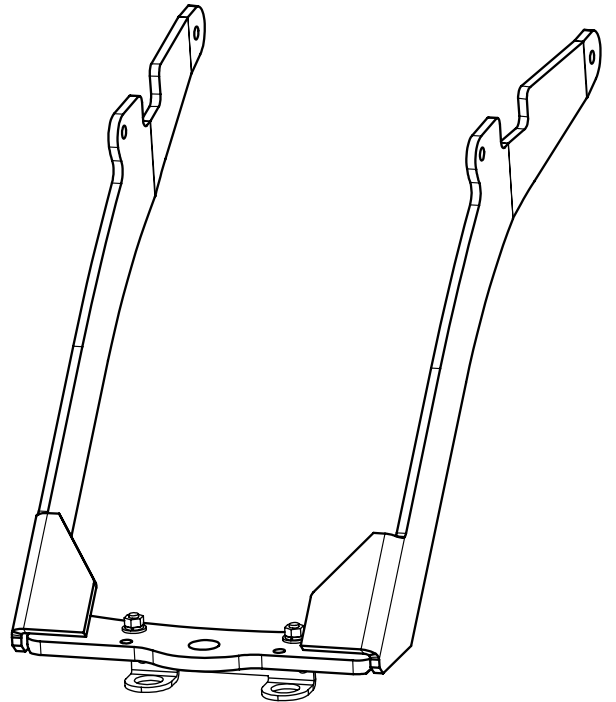
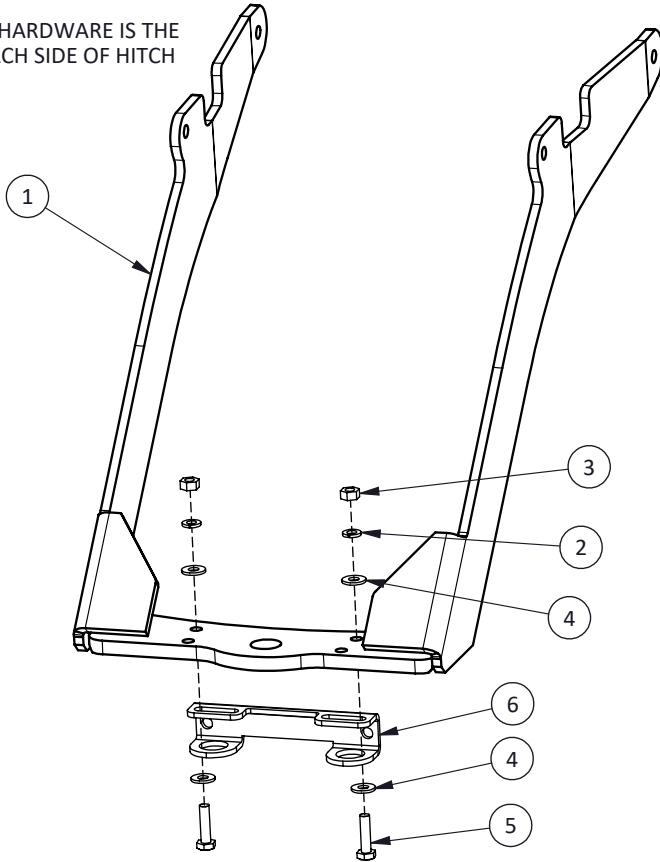

ASSEMBLED VIEW

HDW2994  
REVB ECO 1611

REPRODUCTION IN PART OR AS A WHOLE WITHOUT THE WRITTEN PERMISSION OF HITCHDOC, MFG. IS PROHIBITED.

**\*ALWAYS CHECK BOLT LENGTH FOR TIRE CLEARANCE\***