



131 County Rd. 34 E. Jackson MN, 56143 1.800.446.8222
www.eagleplows.com

2898 – Aodes WorkCross Plow Mount

Use the attached page to help with part identification during installation. We recommend using Loctite (Blue) on all fasteners.

Tools:	
12mm Socket	9/16 Socket
13 mm Socket	9/16 Wrench
Ratchet	

Plow Mount Installation:

STEP 1: Remove the two M10 bolts that attach the lower portion of the bumper to the frame. Lift the plow mount (Item 1) up to the front of the machine and line the ears at the front of the mount up with the holes where the bolts were just removed. Place a flat washer (Item 6) on both of the M10x30mm hex bolts (Item 10) then insert through the holes in the ear and thread into the frame. Do not fully tighten.

STEP 2: Place the frame clamps (Item 2) over the frame centered between the A-Arms on each side of the frame with the holes in the clamps to the outside of the frame and approximately in line with the holes in the plow mount below. Place a 3/8 flat washer (Item 6) on all four of the 3/8x1-1/2” hex bolts (Item 5). Lift the back of the plow mount up so it is flush against the frame and insert the bolts through the holes at the rear of the plow mount and through the corresponding hole in the frame clamp above. Place another 3/8 flat washer on each bolt and then start a 3/8 Nylock nut (Item 4) on each bolt. Do not fully tighten. Repeat for the three remaining 3/8” bolts.

STEP 3: Square the mount up to the front of the machine and then fully tighten all of the hardware working in a crisscross pattern to keep the mount straight.

Attaching the Push Tube to the Plow Mount:

STEP 1: Roll the UTV over the push tube assembly.

STEP 2: Lift the push tube up to the plow mount and line the holes in the ears on the push tube up with the holes in the ears on the plow mount.

STEP 3: Insert each of the 3/4 x 2” clevis pins (Item 8) through the holes and secure in place using the hair pin clips (Item 9).

STEP 4: Attach the lift system of choice and the plow is ready for use.

Removing the Push Tube from the Plow Mount:

Reverse the previous steps to remove the push tube. Once the 3/4” pins are removed, place them back into the holes on the push tube assembly with the hair pin clips to prevent them from getting lost when the plow is not in use.

Additional Notes:

- (Optional) Mount the cable stop (Item 3) using the wire clip (Item 7) along the winch cable to prevent interference between the plow system and the machine when the plow is lifted.

It is the operator's responsibility to periodically check all fasteners/mounting hardware to ensure none have come loose during use and to check for any signs of wear.

Do NOT plow at speeds over 5mph. Doing so will void warranty on any parts that become damaged or break.

ITEM NO.	PART NUMBER	QTY.	DESCRIPTION
1	2898-4	1	PLOW MOUNT WLDMT, AODES
2	2898-5	2	FRAME CLAMP, 1.6W X 2.25H
3	3918-4	1	CABLE STOP
4	H17043	4	NUT, 3/8-16 NYLON-INSERT, ZN
5	HDW393	4	BOLT, 3/8"-16 X 1-1/2 HEX, GR5 ZN
6	HDW1223	10	WASHER, 3/8" FLAT, SAE, ZINC
7	HDW1247	1	3/16 IN WIRE ROPE CLIP
8	HDW1260	2	CLEVIS PIN, 3/4 X 2, ST,ZN
9	HDW1261	2	HAIRPIN, Ø1/8 X 2-1/2" Z
10	HDW1314	2	BOLT, M10-1.25 X 30 HEX 8.8 Z

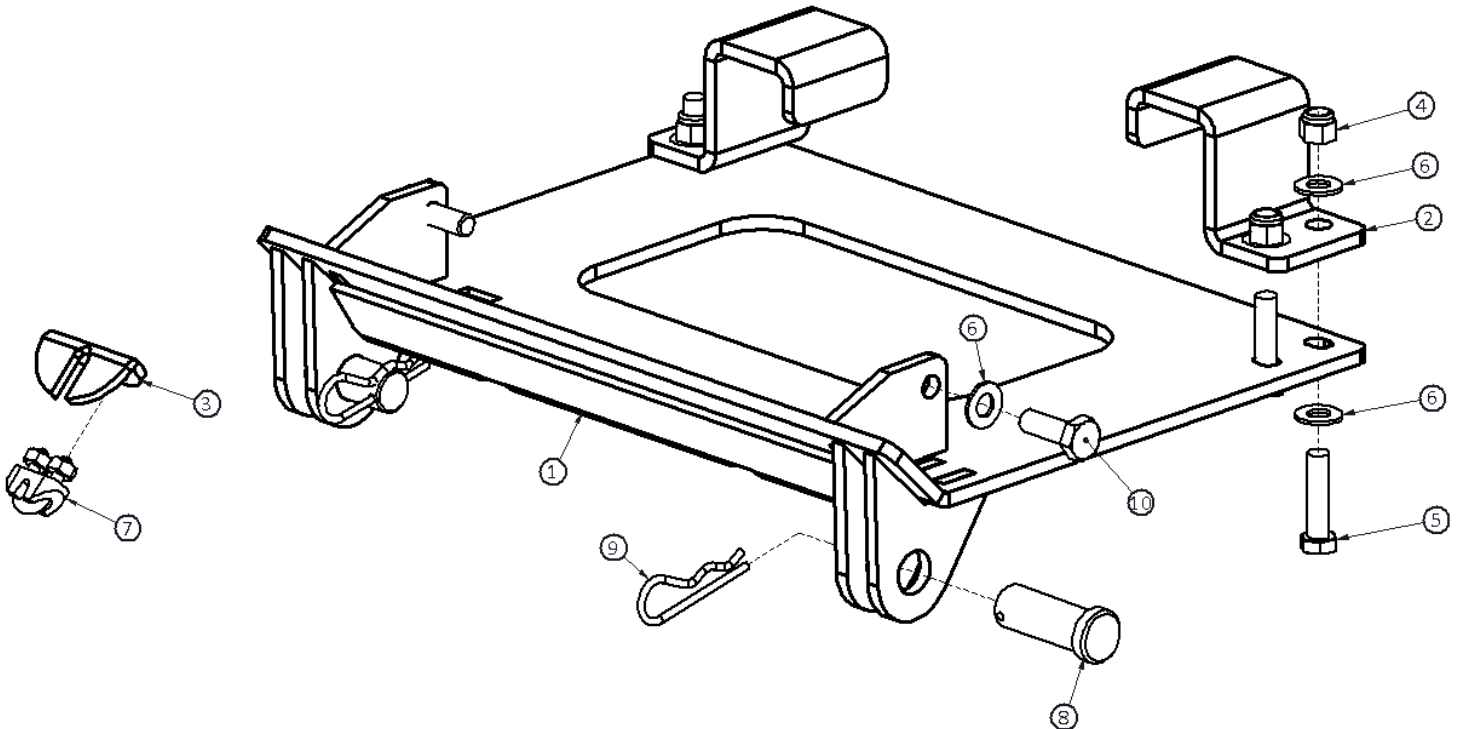

All hardware is a part of HDW3177 hardware kit.