



131 County Rd. 34 E. Jackson MN, 56143 1.800.446.8222
www.eagleplows.com

2840 – Kawasaki 600/610 Mule Plow Mount

TOOLS NEEDED

1/2" WRENCH OR SOCKET 5/16" DRILL BIT AND DRILL

PLOW MOUNT INSTALLATION (use attached page to help with part identification during installation)

- STEP 1: Place the mount straps (Item 2) over the frame horns in front of the differential and line up to the slotted holes in the front of the plow mount (Item 1). Place a 5/16" lock washer (Item 3) and flat washer (Item 5) onto the 5/16" X 2" hex bolts (Item 6) and loosely draw up the bolts into the straps.
- STEP 2: Make sure the plow mount is centered on the machine and use the inside slotted holes in the rear of the mount as a guide to drill through the plastic skid plate. Now place the 5/16" X 1-3/8 x 2-1/4" U-bolts (Item 9) over top of the frame and down through the holes and secure using a 5/16" flat washer (Item 5) and nylock nut (Item 4) on each end of the U-bolts.
- STEP 3: Ensure that the mount is centered on the UTV and tighten all bolts securely.

ATTACHING THE PUSH TUBE

- STEP 1: Roll the UTV over the push tube assembly.
- STEP 2: Lift the push tube up to the plow mount and line the holes up on the push tube and ears on the plow mount.
- STEP 3: Insert 3/4" pins (Item 7) into the holes and snap the hair pin clips (Item 8) into the 3/4" pins.
- STEP 4: Attach the lift system of choice and the plow is ready for use.

REMOVING THE PUSH TUBE

Reverse the above listed steps to remove the push tube. Once the 3/4" pins are removed, place back into the holes on the push tube assembly with the hair pin clips so they are not lost when the plow is not in use.

Periodically check all mounting hardware to make sure the plow mount is properly secured to the UTV.

It is the operator's responsibility to periodically check all fasteners/mounting hardware to ensure none have come loose during use and to check for any signs of wear.

Do NOT plow at speeds over 5mph. Doing so will void warranty on any parts that become damaged or break.

ITEM NO.	PART NUMBER	QTY.	DESCRIPTION
1	2840-4	1	PLOW MOUNT
2	3001	2	MOUNT STRAP WLDMT
3	H17111	4	WASHER, 5/16" SPLIT-LOCK, ZN
4	HDW152	4	NUT, 5/16"-18 NYL-INS HEX, GR5 ZN
5	HDW154	8	WASHER, 5/16 FLAT SAE, ZN
6	HDW1233	4	BOLT, 5/16"-18 X 2, GR5 ZN
7	HDW1260	2	CLEVIS PIN, 3/4 X 2, ST,ZN
8	HDW1261	2	HAIRPIN, Ø1/8 X 2-1/2" Z
9	HDW1647	2	U-BOLT, 5/16-18X1-3/8X2-3/16

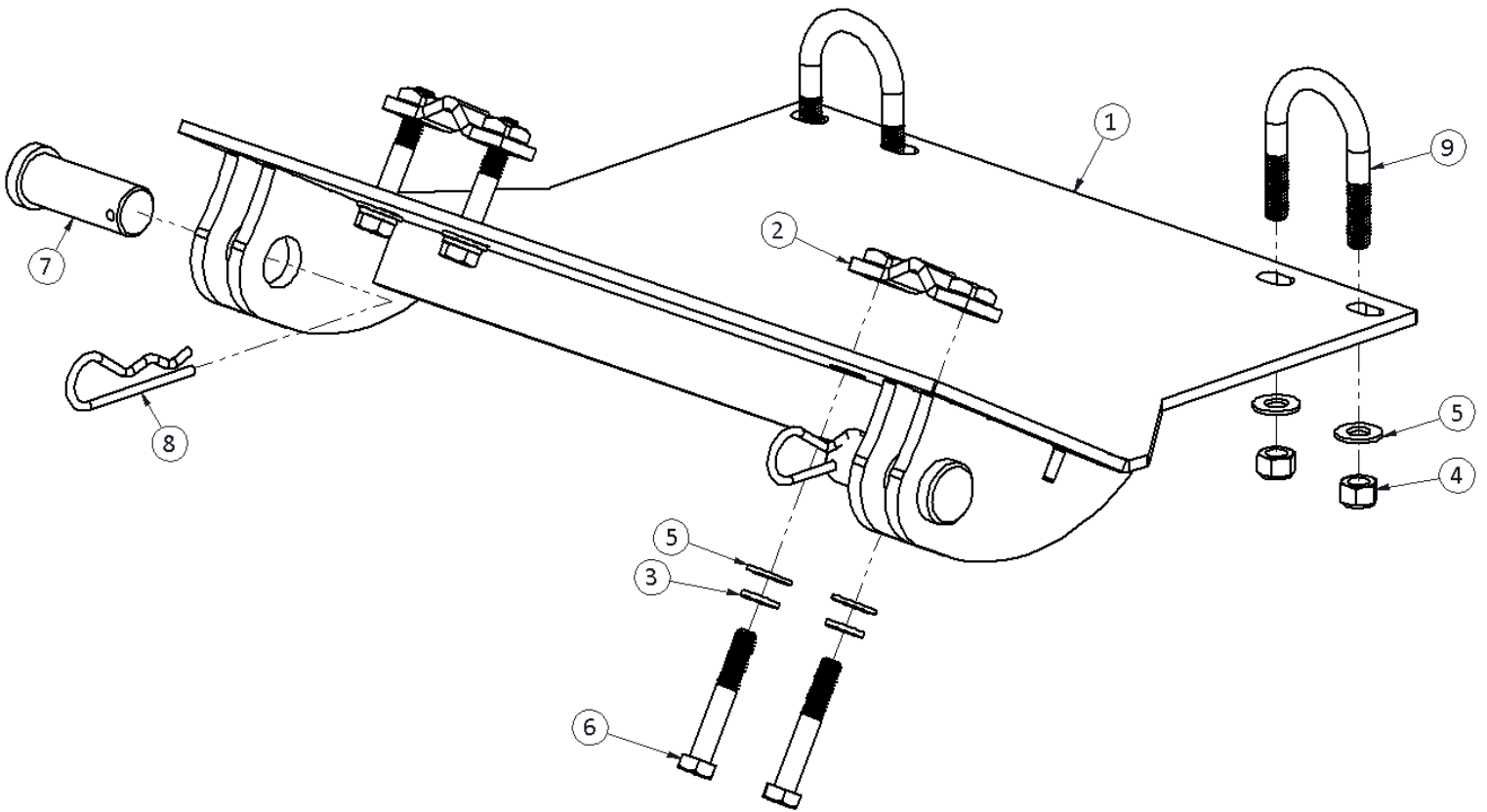

Hardware is from HDW1774 hardware kit.

